

Remembering in Prayer
"Therefore...pray for each other..."(James 5:16)

Betty Allen (Sue Parks' & Clyde Fields' sister)
 Michelle Armstrong (Bob & Melanie Armstrong's daughter-in-law)
 Mary Katherine Atnip (Gary Atnip's mother)

Amanda Bales
 Nick Barrett (Roselyn Wild's cousin)
 Alice Bennett
 Shirley Bennett
 Judy Blankenship (Kristen Blankenship's sister-in-law)
 Angie Bump
 Luke Caldwell, currently serving in Iraq (Betty Downton's grandson)
 Jan Carnaghi
 Lauren Civils (Frances Weaver's daughter)
 Lora Civils (Frances Weaver's granddaughter)
 Helen Crady
 Lillie Creech (Mike & Virginia Plageman's sister-in-law)

Mark Earle
 Bill Felts (Tina Heaton's father)
 Dick Fields (Ed & Linda Clark's friend)
 Thetus Flynn (Ira Flynn's mother)
 Gary Gray
 Ingle Harris
 Kevin Keutzer (Terry Kennedy's brother)

Lisa Lattimer (Kim Clark's sister)
 Betty Manley (Kim Todd's mother)
 Helen Middlemas (currently in rehab)

Leona Papenbrock (Teri Short's grandmother)
 Wendy Peebles
 Karen Peck (Brian Carnes' sister)
 Kelly Pieratt
 David Portteus (Joan Cole's brother)
 Ruth Rady (Steve Rady's mother)
 Tim Reckel (Ron & Carolyn Anderson's friend)

Bob Rembish (Mike & Virginia Plageman's friend)
 Michael Riggins
 Charlie Roberts (Kristen Blankenship's uncle)

Jan Roberts (Kristen Blankenship's aunt)
 Don Roller
 Darrell Shaw
 Teri Short
 Zona Spencer
 Laura Steele (Vicki Rady's mother)
 Russ Warwick
 Erich Wild
 Judy Williams (friend of the Rollers)
 Tammy Wilson (Nic, Nicole & Vic Wilson's mother) (currently in rehab)

(Boldface denotes those hospitalized or having surgical procedures this past week.)

Homebound, Nursing Homes, and Assisted Living:

Jeri Berkholz: Masonic Home Medical Center #131, 690 State St., Franklin 46131
Agnes Earle (Glenda Hoffman's grandmother): Brownsburg Rehab., 1010 Hornaday Rd., Brownsburg, IN 46112
Rosetta Kindred: Manor Care Hlth. Services, 8549 Madison Ave. #129-A, Indpls, 46227
Helen Middlemas: 2109A Crossing Terrace, Greenfield 46140
Paul Neal (Lloyd Neal's brother): Univ. Heights N.H., 1380 E. County Line Rd., Indpls, 46227
Mary Portteus (Joan Cole's mother): Forest Creek Commons, 6510 US 31 S, Apt. 9, Indpls, 46227
Mildred Richards: Univ. Heights N.H., 1380 E. County Line Rd., Indpls, 46227
Mable Snapp: 8805 Madison Avenue, #304B, Indianapolis 46227
Clare Stone: Franklin UM Community #E220, 1070 W. Jefferson, Franklin 46131

Our sympathy to
 Mary Ann Hibler and
 her family at the loss of
 her husband, Jerry Hibler,
 on January 3, 2010.

Congratulations to
 Mildred Lear on the birth of
 her great-granddaughter,
 Savana Kathleen Simpson,
 on January 1, 2010.

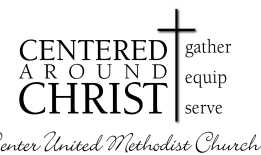
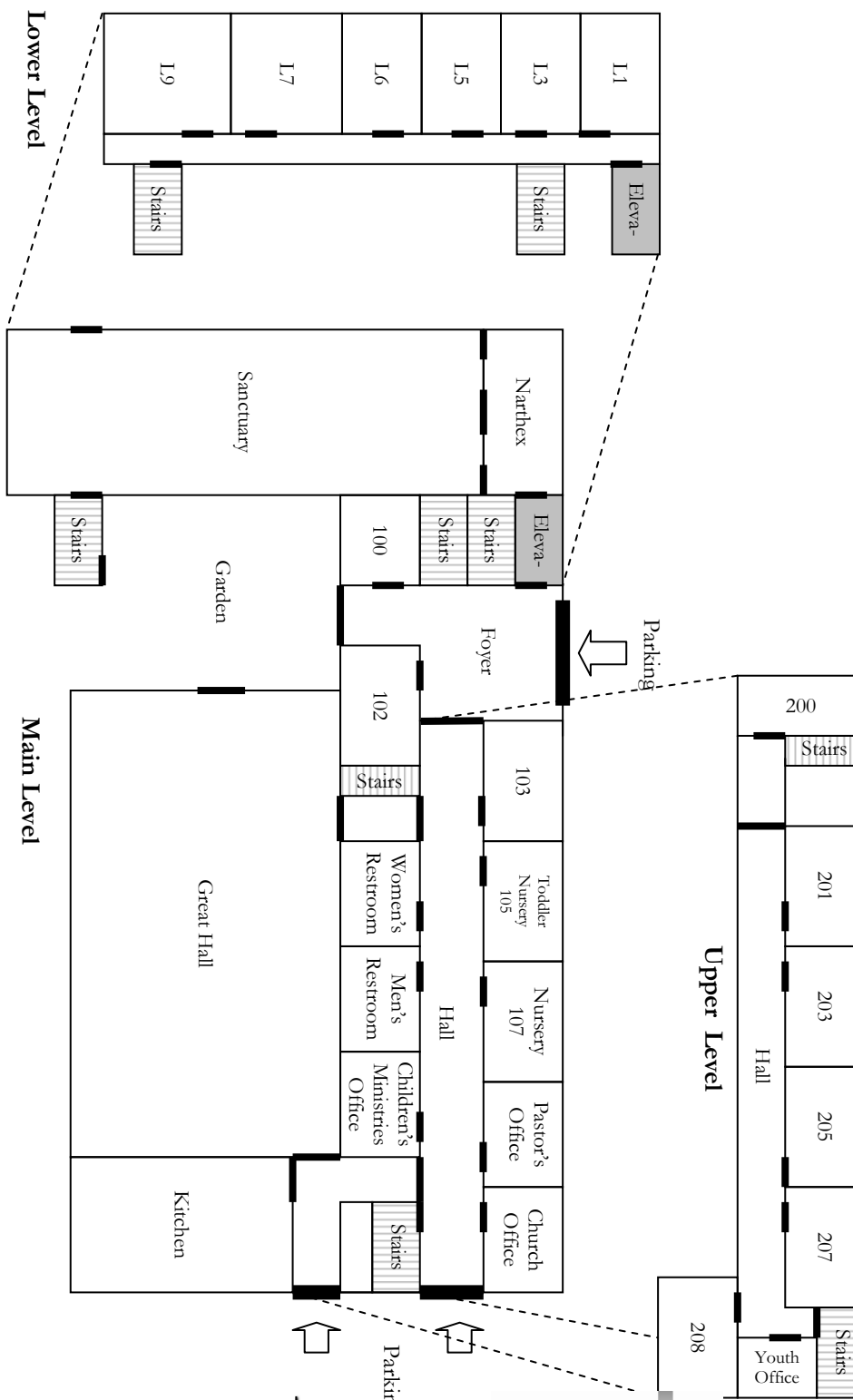

Center United Methodist and The Living Well

Church Office: 784-1101—Sr. Pastor's Home: 882-9099—Prayer Line: 767-0768
Web Site: www.center-umc.org—E-Mail: info@center-umc.org
 Music Director, Bruce Haddix
 Nursery Coordinator, Vanessa Carnes
 Office Manager, Charlotte Whitaker
 Organist, Ann Haddix
 Praise Team Leader, Teri Short
 Senior Pastor, Daniel D. Rasmussen
 Treasurer, Kristen Blankenship
 Wedding Director, Clance LaTurner
 Wedding Advisor, Alissa Newhouse
 Wedding Advisor, Suzi Tolliver
 Youth Ministries Director, Cheryl Adamson

Center United Methodist and The Living Well

5445 Bluff Road, Indianapolis, IN 46217
 January 10, 2010

Worship Services

Traditional (Sanctuary), 9:00 a.m.
 Contemporary (Great Hall), 11:15 a.m.

Sunday School

10:15 - 11:05 a.m.

Welcome! We're glad you're here!

Here is some information to help you get acquainted with us.

Families may choose safe, clean, well-supervised options for children of all ages: (see map on the back of the bulletin)

- **NURSERY** for children ages 2 and younger in room 107
- **TODDLER ROOM** for children ages 2 - 3 in room 105
- **CHILDREN'S WORSHIP** for children ages 4 - 4th grade in room L7

Children are invited to attend our Children's Worship, God's Kids, a fun and interactive worship celebration kid-style! Children ages 4 through 4th grade are welcome to join us in room L7 after being dismissed from the regular worship services. We will celebrate God's love and learn God's truth in ways kids understand and enjoy. It's not required, so please do what works best for your family. Parents are always welcome to check it out along with their children.

Each Sunday from 10:15 to 11:05 a.m. we offer **SUNDAY SCHOOL** for children, youth, and adults. It is a great way to meet people and grow in your faith!

If you have a prayer request or praise to share with the congregation, please call our **PRAYER CHAIN** at **767-0768** and leave your message. If you would like to receive prayer requests by e-mail, Ameritech voice mail or by a regular phone call, please call Prayer Chain Captain **Sue Parks** at **888-8292** or e-mail **parksms@sbcglobal.net** to be added to the list. Prayers work!

NEED TO PRAY? The church is open during office hours, 8:30 a.m. - 3:45 p.m. Monday through Thursday and until 1:00 p.m. on Friday, to everyone who would like to pray in the sanctuary or the prayer room or during evening meetings when the sanctuary or the prayer room are not in use.

If you have a **SUBMISSION** that you would like to be published in the **CENTERVIEW** and/or the **CHURCH BULLETIN**, please have your submission turned into the office by the 15th of the month for it to be published in the next month's Centerview or by Wednesday for the following Sunday's bulletin.

2010 FLOWER CALENDAR—The calendar is posted in the hall next to Pastor Dan's office. All you need to do is write down your message of honor or memory for your loved one on an available day and the flowers will be yours at the end of the 9:00a.m. Sanctuary worship service. Flowers are \$15 for both bouquets. Flowers left after Sunday worship may be used for shut-in or hospital visitation. Please call the church office at 784-1101 if you have any questions.

Fellowship Opportunities

THE UNITED METHODIST WOMEN—The UMW will meet on Wednesday, January 13th at 9:30a.m. in room L7. Jessi Langley, the executive director of Fletcher Place, will be our guest speaker. Anyone interested in hearing our guest speaker is welcome to attend. Please contact **Sue Parks** at **888-8292** for more information.

THE WEIGHT LOSS GROUP—We are now meeting in L3 on Wednesday Nights from 7:00-8:00pm. We just started a new series, but there is still time to join us! We will be doing the original (1997) *Weigh Down Workshop* video series and workbook. Please contact **Kristen Blankenship** at **784-1093** or **kristenblanken@aol.com** if you are interested in joining us. Blessings!

WORSHIP ATTENDANCE FOR SUNDAY, JANUARY 3, 2010:

Center 9:00 AM Service = **103**. The Living Well 11:15 AM Service = **132**.

Children's Worship = **48**. Total = **283**. Sunday School = **126**.

January 4, 2009: Center 10:15 AM Service = 148. The Living Well 10:15 AM Service = 132.

Children's Worship = 54. Total = 334. Sunday School = 118.

Important Information

BABY BLANKETS—Baby blankets for sale, \$20 each. Proceeds will go to UMW mission projects. Call **Sue Parks** at **888-8292** to purchase.

CHILDREN'S CHOIR PRACTICE—The 3rd, 4th & 5th grade children's choir will resume practice on Sunday, January 17th at 5p.m. in room L7. For more information, contact Alissa Newhouse (**781-1432** or **ranewhouse@comcast.net**.)

THE DAILY WALK BIBLES—The Daily Walk Bibles are still available in the church office. Hard cover Bibles are \$19.59. (Soft cover Bibles are sold out.)

YOUTH VALENTINE'S DINNER—The Youth Valentine's Dinner will be Saturday, February 13th at 6:30p.m. There will only be 136 tickets available for the dinner and we will begin selling tickets on Sunday, January 17th. This year we would like to use pictures of your loved ones to create a slide show. These pictures can be wedding pictures, family pictures or any other pictures that show people you love. Take your pictures to the church office; Charlotte will scan and copy your pictures and return them to you. If you have any questions about the dinner or the slide show, please contact Cheryl Adamson (**787-5426** or **cadamson87@yahoo.com**.)

Ministry Opportunities

PRAYER SHAWL MINISTRY—The UMW continues to support the Prayer Shawl Ministry. If you would like to contribute to this ministry, you can do so by giving yarn or money to purchase yarn. We also need people to crochet or knit the shawls. We have a pattern for both. If you would like to learn to crochet, please contact Connie Minton. The crochet class we have been having on Thursday afternoon will be held only if someone lets Connie know they will be there. Call **Connie** at **783-9579** or **902-5960**. The shawls are given to individuals who have experienced a traumatic event in their lives or are suffering from an illness. These individuals do not have to be a member of the church. What better way to touch them, than by giving them something to wrap up in and feel God's presence through our prayers?

SUNDAY MORNING HOSPITALITY—If you have discovered that one of your spiritual gifts is the gift of hospitality and would like to help serve your friends here at Center, please contact **Lesley Markley** (**862-6360** or **lemarkley@yahoo.com**.) We need your help to make sure coffee/refreshments are "refreshed" before the 9:00a.m. service. Please contact Lesley if you would like to volunteer!

Menu for the new Homeless Hot Meal, Saturday January 16th

Chili, Canned Fruit and Homemade Desserts

We need donations of the ingredients for the chili (hamburger, red beans, canned tomatoes, etc...) and desserts.

Please leave non-perishable donations in the green laundry basket marked "Homeless Donations" located under the mailboxes across from the church office. Please call Glenda or Julie to advise of perishable donations that cannot be put in the basket.

GLENDA HOFFMAN @ 834-1414 OR JULIE RAASCH @ 786-3138

This Week's Activities

Sunday, January 10, 2010

9:00 AM
9:45 AM - 10:45 AM
10:15 AM - 11:05 AM
11:15 AM
12:30 PM - 4:00 PM

4:30 PM - 6:00 PM
5:00 PM
5:00 PM

Monday, January 11, 2010

11:00 AM - 2:30 PM
4:10 PM - 5:10 PM
7:00 PM - 8:30 PM

Tuesday, January 12, 2010

10:30 AM
11:00 AM - 2:30 PM

Wednesday, January 13, 2010

6:30 AM
9:30 AM
11:00 AM - 2:30 PM
3:50 PM - 4:50 PM
6:00 PM
6:30 PM
6:30 PM
7:00 PM
7:00 PM - 8:00 PM
8:00 PM
8:00 PM

Thursday, January 14, 2010

10:00 AM - 11:00 AM
11:00 AM - 2:30 PM
6:30 PM

Friday, January 15, 2010

11:00 AM - 2:30 PM
6:30 PM

Saturday, January 16, 2010

8:00 AM - 10:00 AM
8:30 AM - 1:00 PM

1:00 PM - 5:00 PM

Sunday, January 17, 2010

9:00 AM
9:45 AM - 10:45 AM
10:15 AM - 11:05 AM
11:15 AM
12:30 PM - 4:00 PM

4:30 PM - 6:00 PM
5:00 PM
5:00 PM
6:00 PM

Today's Reading: Genesis 25-26

Traditional Worship (Sanctuary)
Praise Team Practice (Great Hall)
Sunday School (Classrooms)
Contemporary Worship (GH)
Chin Congregation Worship (Sanctuary, L7 & Kitchen)
Youth Praise Band Practice (208)
Middle School Youth Group (203)
Youth Parent Meeting, Meal & Games (L7)

Today's Reading: Genesis 27-31

PTRE (L7)
Zumba Class (Great Hall)
Boy Scout Troop 183 (Great Hall)

Today's Reading: Genesis 32-36

Bible Study (L1)
PTRE (L7)

Today's Reading: Genesis 37-40

Bible Study (Flying J Truck Stop)
UMW (L7)
PTRE (L7)
Zumba Class (Great Hall)
Handbell Choir Practice (L9)
Hoffman Bible Study (L7)
Young Women's Bible Study (Cheryl's House)
Chancel Choir (Sanctuary)
Weight Loss Group (L3)
Thru-the-Bible (L1)
Young Men's Bible Study (201)

Today's Reading: Daily Walk Bible Devotional

Prayer Group (Library)
PTRE (L7)
Pack 183 (Great Hall)

Today's Reading: Genesis 41-44

Pastor Dan's Day Off
PTRE (L7)
Scrapbooking (Great Hall)

Today's Reading: Genesis 45-47

Homeless Hot Meal
Women's Bible Study (L7)
Ad Council Retreat (Baymont Inn - Greenwood)
Private Party (Great Hall)

Today's Reading: Genesis 48-50

Traditional Worship (Sanctuary)
Praise Team Practice (Great Hall)
Sunday School (Classrooms)
Contemporary Worship (GH)
Chin Congregation Worship (Sanctuary, L7 & Kitchen)
Youth Praise Band Practice (208)
3rd-5th Grade Choir Practice (L7)
Middle School Youth Group (203)
High School Youth Group (201)